

SONOFF

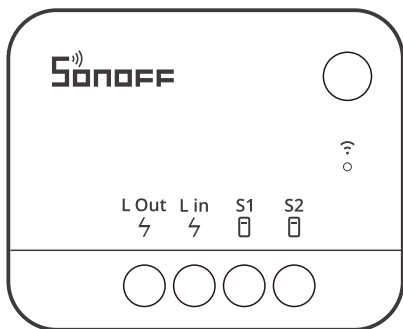

ZBMINI Extreme

User manual V1.1



Zigbee Smart Switch

(No Neutral Required)

产品介绍

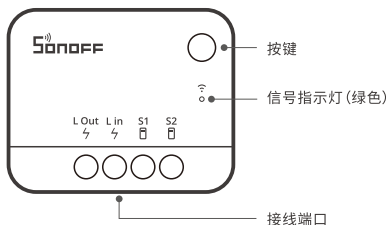

⚠ 设备重量 < 1Kg, 建议安装高度 < 2米。

指示灯状态说明

| 指示灯状态 | 状态说明 |
|----------------------|--|
| 绿灯慢闪 | 配对模式 |
| 绿灯常亮 (继电器处于打开状态时) | 网络连接正常 |
| 绿灯快闪 (继电器处于打开状态时) | 网络连接异常 ZBMINI Extreme与父设备连接正常, 路由器与网关断连 |
| 绿灯慢闪 | 网络连接异常 非配网状态下慢闪: ZBMINI Extreme与父设备断连 |

功能特点

SONOFF 单通道单火开关改装件, 作为 Zigbee 子设备, 可通过连接 Zigbee 网关实现远程控制、设置定时开/关、设备智能场景联动等功能。



远程控制



智能定时/延时



语音控制



OTA升级



智能场景



外接开关



上电状态



添加摄像头

⚠ 以上功能特点取决于 Zigbee 网关的功能。

设备安装

1. 断电

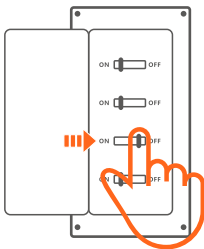

⚠ 设备安装、故障维修请由专业资质电工操作。切勿在设备通电时进行接线操作或触碰到接线端子，以免发生触电危险！

2. 接线

为确保电气安装的安全，必须在ZBMINI2前面安装符合国家安全标准额定电流为6A的微型断路器（MCB）或漏电保护断路器（RCBO）。

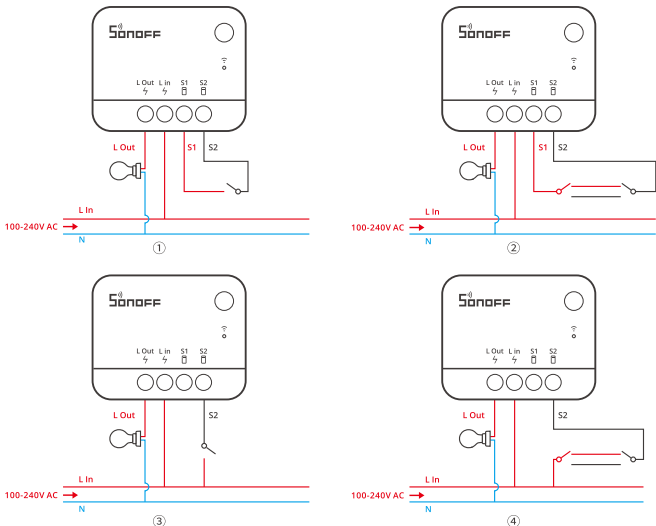

ⓐ 以上③④接线方式请确保设备 L in 端供电输入正常，否则会导致设备工作异常。

- ⓘ 外接的开关类型支持翘板和自回弹开关，出厂默认为支持翘板开关类型。
- ⓘ 本设备不支持其它类型的感性负载如风扇等。
- ⓘ 确保线路接入无误。

配对至易微联App

1. 下载“易微联”App



2. 添加SONOFF Zigbee网关

3. 上电

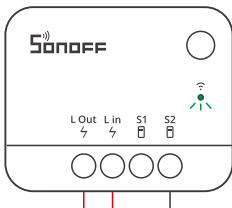

通电后，设备首次使用，默认进入配对模式，绿色指示灯呈“慢闪”状态。

- ⓘ 三分钟内没下一步操作，设备将退出配对模式，如需再次进入，长按设备按键5秒直到绿色指示灯呈“慢闪”状态即可。
- ⓘ 当设备处于配网状态时，设备保持关闭状态，不受设备按键或外接开关的控制。

4. 将 ZBMINI Extreme 添加至网关

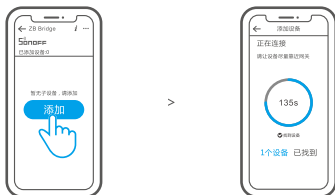

打开eWeLink App, 在网关界面, 点击 "添加" 子设备, 等待搜索添加子设备。

配对至亚马逊音箱

1. 下载最新版Amazon Alexa App, 并配对带Zigbee网关的亚马逊音箱。
2. 给 ZBMINI Extreme 上电, 设备默认进入配对模式, 绿色信号指示灯呈“慢闪”状态。

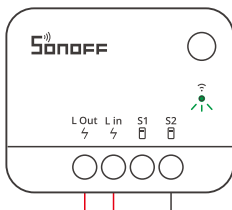

⊙ 当设备处于配网状态时, 设备保持关闭状态, 不受设备按键或外接开关的控制

3. 对亚马逊音箱说 "Alexa, discover my devices", 即可自动发现设备。

⊙ 三分钟内没配对成功, 设备将退出配对模式, 长按设备按键5S使其再次进入配对模式。

将开关切换到对应的类型

出厂默认为支持翘板开关类型，如需切换开关类型，短按按键三次且绿灯快闪3下，此时开关类型切换成功。

⚠ 请在设备放进暗盒前切换到对应的开关类型。

将ZBMINI Extreme安装在暗盒中

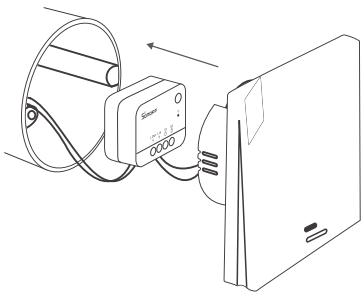

产品参数

| | |
|------|---|
| 产品型号 | ZBMINI2 |
| 输入 | 100-240V AC 50/60Hz 6A Max |
| 输出 | 100-240V AC 50/60Hz 6A Max |
| 最大负载 | ☼ 阻性负载: 6A Max LED: 150W Max @100V, 300W Max @240V |
| 无线连接 | Zigbee 3.0 |
| 工作温度 | -10~40°C |
| 外壳材料 | PC V0 |
| 产品规格 | 39.5x32x18.4mm |

恢复出厂设置

可通过以下任意方法让设备恢复出厂设置(恢复出厂设置后设备自动进入配对模式):

1. 连接外接开关10下。
2. 长按设备按键5秒。
3. 在 eWeLink App 端删除子设备。

支持的语音平台



执行标准: GB/T 16915.2

产品中有害物质的名称及含量

| 部件名称 | 有害物质 | | | | | |
|-------|--------|--------|--------|--------------|------------|--------------|
| | 铅 (Pb) | 汞 (Hg) | 镉 (Cd) | 六价铬 (Cr(VI)) | 多溴联苯 (PBB) | 多溴二苯醚 (PBDE) |
| 塑料件 | o | o | o | o | o | o |
| 电子元器件 | x | o | o | o | o | o |
| 包装盒 | o | o | o | o | o | o |
| PCB板 | o | o | o | o | o | o |
| 五金件 | o | o | o | o | o | o |

本表格依据SJ/T 11364 的规定编制:

o: 表示该有害物质在该部件所有均质材料中的含量均在GB/T 26572规定的限量要求以下;
x: 表示该有害物质至少在该部件的某一均质材料中的含量超出GB/T 26572规定的限量要求。

微功率设备使用说明

(一) 本产品使用的 Zigbee 技术符合“微功率短距离无线电发射设备目录和技术要求”中通用微功率设备F类设备的技术要求,用于数据传输应用。采用一体化天线,控制、调整及开关等使用方法请参考产品说明书中相关内容;

(二) 不得擅自改变使用场景或使用条件、扩大发射频率范围、加大发射功率(包括额外加装射频功率放大器),不得擅自更改发射天线;

(三) 不得对其他合法的无线电台(站)产生有害干扰,也不得提出免受有害干扰保护;

(四) 应当承受辐射射频能量的工业、科学及医疗(ISM)应用设备的干扰或其他合法的无线电台(站)干扰;

(五) 如对其他合法的无线电台(站)产生有害干扰时,应立即停止使用,并采取措施消除干扰后方可继续使用;

(六) 在航空器内和依据法律法规、国家有关规定、标准划设的射电天文台、气象雷达站、卫星地球站(含测控、测距、接收、导航站)等军民用无线电台(站)、机场等的电磁环境保护区域内使用微功率设备,应当遵守电磁环境保护及相关行业主管部门的规定;

(七) 禁止在以机场跑道中心点为圆心、半径5000米的区域内使用各类模型遥控器;

(八) 微功率设备使用温度为-10~40℃,供电为100-240V~,6A.

Product introduction

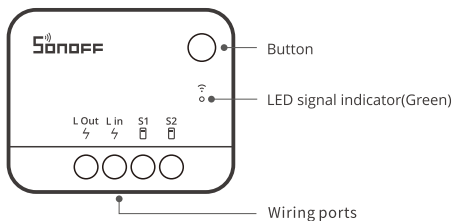

ⓘ The device weight is less than 1kg, and the recommended installation height is less than 2m.

LED indicator status instruction

| LED indicator status | Status instruction |
|--|---|
| Green LED indicator slow flashes | Pairing mode |
| Green LED indicator keeps on (Relay is powered on) | Device is on line |
| Green LED indicator quick flashes (Relay is powered on) | Abnormal network connection ZBMINI Extreme and router connect normally, but router and the hub are disconnected |
| Green LED indicator slow flashes (Relay is powered on) | Abnormal network connection Slow flashing under non-pairing state: ZBMINI Extreme and the parent device are disconnected |

Features

SONOFF Zigbee smart switch (No neutral required) allows you to remote control, schedule on/off and set smart scenes to trigger other devices, etc. by connecting Zigbee hub.



Remote Control



Single/Countdown
Timing



Voice Control



OTA Upgrade



Smart Scene



External Switch



Power on State



Camera Linking

ⓘ Above functions are determined by the connected Zigbee Hub.

Installation

1. Power off

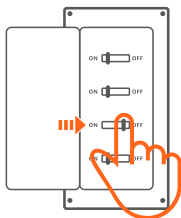

⚠ Please install and maintain the device by a professional electrician. To avoid electric shock hazard, do not operate any connection or contact the terminal connector while the device is powered on!

2. Wiring instruction

To ensure the safety of your electrical installation, it's essential either a Miniature Circuit Breaker (MCB) or a Residual Current operated Circuit-breaker with Integral Overcurrent protection (RCBO) with an electrical rating of 6A has been installed before the ZBMINI L2.

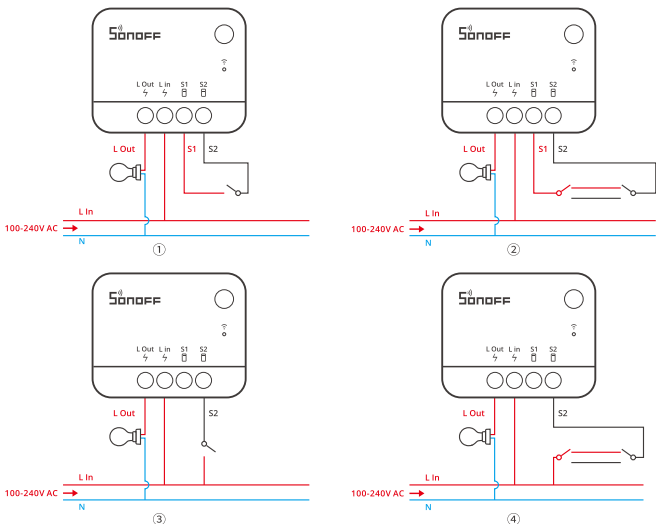

⚠ For the above ③④ wiring methods, please ensure the proper wiring and powering of the L in terminal, otherwise it will cause the device to work abnormally.

- ⓘ Supported switches are rocker switch and push button and factory default by supporting rocker switch.
- ⓘ Unsupported to use with other Inductive loads such as fan.
- ⓘ Make sure all wires are connected correctly.

Pair with eWeLink App

1. Download the eWeLink App



2. Pair SONOFF Zigbee Bridge to your eWeLink account

3. Power on

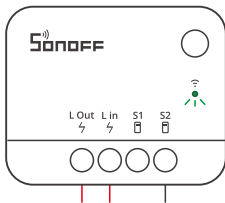

After powering on, the device will enter the pairing mode defaulted during the first use and the green LED indicator will "flash slowly".

- ⓘ The device will exit the pairing mode if you do not operate it within 3mins. If you want to enter the pairing mode again, press and hold the button of the device for 5 seconds until the green Led indicator "flashes slowly" and releases.
- ⓘ The device will remain off and cannot be controlled by the device's button or external switch when it is in pairing mode.

4. Add ZBMINI Extreme to the ZB Bridge

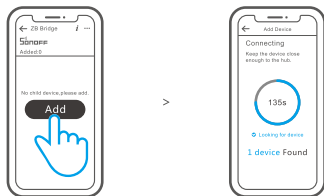

Open eWeLink App, tap "Add" icon on the ZB Bridge interface, then wait to looking for and add the sub-devices.

Pair with Amazon Echo

1. Download the latest Amazon Alexa App and pair it with Amazon Echo with built-in Zigbee hub.
2. Power on ZBMINI Extreme, then it defaulted to enter the pairing mode and the green LED indicator "flashes slowly".

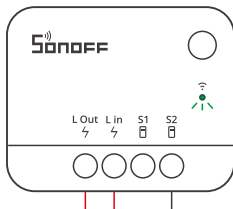

⚠ The device will remain off and cannot be controlled by the device's button or external switch when it is in pairing mode.

3. Ask the Alexa Echo to discover the devices automatically by saying "Alexa, discover my devices".

⚠ If failed to pair within 3mins, ZBMINI Extreme will exit the pairing mode. Long press the button on ZBMINI Extreme for 5s to make it enter the pairing mode if you need to pair again.

Switch the device to the corresponding switch

The device supports rocker switch by default. If you want to change the switch type, press the button 3 times and see the green Led indicator flash 3 times quickly, then the switch type is switched successfully.

⚠ Please switch to the corresponding switch type before installing the device in the mounting box.

Install the ZBMINI Extrene in the mounting box

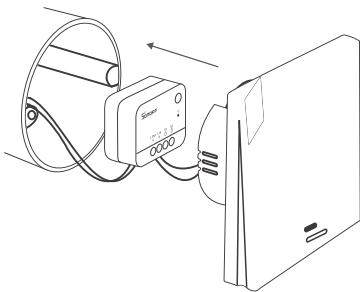

Specifications

| | |
|---------------------|---|
| Model | ZBMINIL2 |
| Input | 100-240V AC 50/60Hz 6A Max |
| Output | 100-240V AC 50/60Hz 6A Max |
| Max. load |  Resistive load: 6A Max LED: 150W Max @100V, 300W Max @240V |
| Wireless connection | Zigbee 3.0 |
| Working temperature | -10~40°C |
| Casing material | PC V0 |
| Product Size | 39.5x32x18.4mm |

Factory reset

Return the device to its factory settings in any following ways (Device will enter the pairing mode automatically after resetting)

1. Press 10 consecutive times the connected external switch
2. Long-press the device for 5s.
3. Delete the sub-device on eWeLink App

Supported voice assistant



FCC compliance statement

1.This device complies with part 15 of the FCC Rules. Operation is subject to the following two conditions:

- (1) This device may not cause harmful interference, and
- (2) This device must accept any interference received, including interference that may cause undesired operation.

2.Changes or modifications not expressly approved by the party responsible for compliance could void the user's authority to operate the equipment.

Note: This equipment has been tested and found to comply with the limits for a Class B digital device, pursuant to part 15 of the FCC Rules. These limits are designed to provide reasonable protection against harmful interference in a residential installation. This equipment generates, uses and can radiate radio frequency energy and, if not installed and used in accordance with the instructions, may cause harmful interference to radio communications. However, there is no guarantee that interference will not occur in a particular installation. If this equipment does cause harmful interference to radio or television reception, which can be determined by turning the equipment off and on, the user is encouraged to try to correct the interference by one or more of the following measures:

- Reorient or relocate the receiving antenna.
- Increase the separation between the equipment and receiver.
- Connect the equipment into an outlet on a circuit different from that to which the receiver is connected.
- Consult the dealer or an experienced radio/TV technician for help.

FCC Radiation Exposure statement:

This equipment complies with FCC radiation exposure limits set forth for an uncontrolled environment.

This equipment should be installed and operated with minimum distance of 20 cm between the radiator and your body.

This transmitter must not be co-located or operating in conjunction with any other antenna or transmitter.

ISED Notice

This device contains licence-exempt transmitter(s)/receiver(s) that comply with Innovation, Science and Economic Development Canada's licence-exempt RSS(s). Operation is subject to the following two conditions:

- (1) This device may not cause interference.
- (2) This device must accept any interference, including interference that may cause undesired operation of the device.

This Class B digital apparatus complies with Canadian ICES-003(B).

This device complies with RSS-247 of Industry Canada. Operation is subject to the condition that this device does not cause harmful interference.

L'émetteur/récepteur exempt de licence contenu dans le présent appareil est conforme aux CNR d'Innovation, Sciences et Développement économique Canada applicables aux appareils radio exempts de licence. L'exploitation est autorisée aux deux conditions suivantes :

- (1) L'appareil ne doit pas produire de brouillage;
- (2) L'appareil doit accepter tout brouillage radioélectrique subi, même si le brouillage est susceptible d'en compromettre le fonctionnement.

Cet appareil numérique de la Classe B conforme à la norme NMB-003(B) du Canada.

Cet appareil est conforme à la norme RSS-247 d'Industrie Canada. Le fonctionnement est soumis à la condition que cet appareil ne provoque pas d'interférences nuisibles.

ISED Radiation Exposure Statement

This equipment complies with ISED radiation exposure limits set forth for an uncontrolled environment.

This equipment should be installed and operated with minimum distance of 20 cm between the radiator and your body.

This transmitter must not be co-located or operating in conjunction with any other antenna or transmitter.

Cet équipement est conforme aux limites d'exposition aux rayonnements de la ISED établies pour un environnement non contrôlé.

Cet équipement doit être installé et fonctionner à au moins 20cm de distance d'un radiateur ou de votre corps.

Cet émetteur ne doit pas être co-localisé ou fonctionner en conjonction avec une autre antenne ou un autre émetteur.

For CE Frequency

Operation frequency Range

Zigbee: 2405-2480MHz

RF output Power

Zigbee: $\leq 13\text{dBm}$

SAR Warning

Under normal use of condition, this equipment should be kept a separation distance of at least 20 cm between the antenna and the body of the user.

Dans des conditions normales d'utilisation, cet équipement doit être maintenu à une distance d'au moins 20 cm entre l'antenne et le corps de l'utilisateur.

WEEE Disposal and Recycling Information



All products bearing this symbol are waste electrical and electronic equipment (WEEE as in directive 2012/19/EU) which should not be mixed with unsorted household waste. Instead, you should protect human health and the environment by handing over your waste equipment to a designated collection point for the recycling of waste electrical and electronic equipment, appointed by the government or local authorities. Correct disposal and recycling will help prevent potential negative consequences to the environment and human health. Please contact the installer or local authorities for more information about the location as well as terms and conditions of such collection points.

EU Declaration of Conformity

Hereby, Shenzhen Sonoff Technologies Co., Ltd. declares that the radio equipment type ZBMINIL2 is in compliance with Directive 2014/53/EU. The full text of the EU declaration of conformity is available at the following internet address:

<https://sonoff.tech/compliance/>

| | |
|---|---------|
| Scatola | Manuale |
| PAP 21 | PAP 22 |
| Carta | Carta |
| RACCOLTA | |
| Verifica le disposizioni del tuo Comune. Separa le componenti e conferiscile in modo corretto. | |

SONOFF

Shenzhen Sonoff Technologies Co., Ltd.
3F & 6F, Bld A, No. 663, Bulong Rd, Shenzhen, GD, China
ZIP code: 518000 Website: sonoff.tech
Service email: support@itead.cc
MADE IN CHINA



Points de collecte sur www.quefairedemesdechets.fr
Privilégiez la réparation ou le don de votre appareil !

